

TIG Torches Water Cooled

Model 424: 500 Amp Torch

- Silicone rubber insulation
- Rainbow, color-coded, sheath protected hoses, connect and disconnect without tools
- Tapered design—no gaskets, insulators or seals
- AC rated for amperage performance
- 100% continuous duty cycle, DC straight polarity
- "Lectro-Lock" instant backcap for releasing of electrodes
- Accommodates 3" - 7" (75-180 mm) electrode length
- Uses alumina ceramic and Quartz Nozzles
- Electrode size: .020" - 3/16"
- Has replaceable teflon nozzle gasket

Part No. 424-12 12' Torch Assembly
Part No. 424-25 25' Torch Assembly

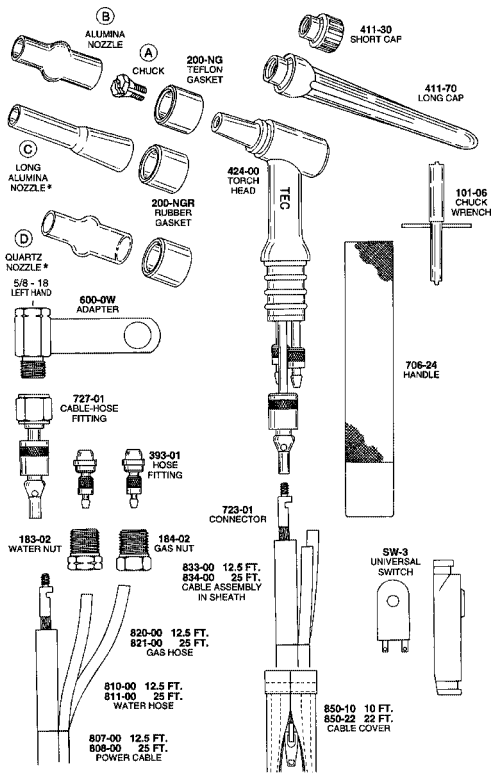

Model 427: 650 Amp Torch

- Silicone rubber insulation
- Extended handle to protect hand from reflected heat
- Rainbow, color-coded, sheath protected hoses, connect and disconnect without tools
- Tapered design—no gaskets, insulators or seals
- AC rated for amperage performance
- 100% continuous duty cycle, DC straight polarity
- Positive front locking of electrode
- Accommodates 2-1/2" electrode
- Uses alumina ceramic
- Electrode size: 1/8" - 5/16"

Part No. 427-12 12' Torch Assembly
Part No. 427-25 25' Torch Assembly

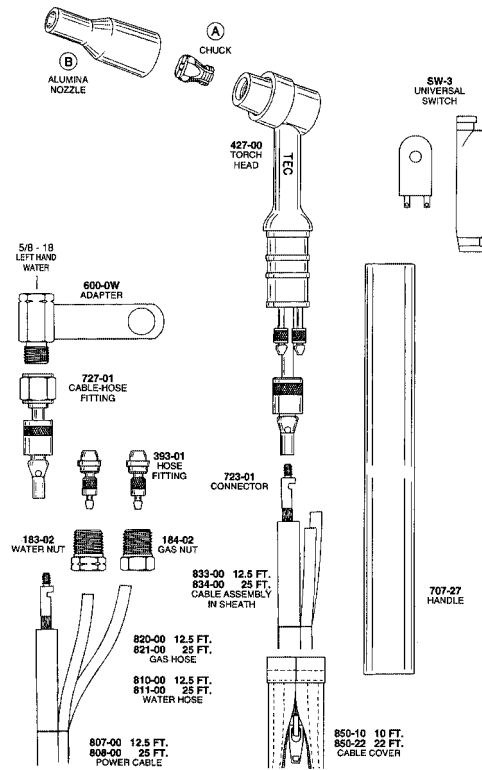

A. Chucks

Part No.	Diameter	mm
220-05	.020	0.5
220-00	.040	1.0
221-00	1/16	1.6
222-00	3/32	2.4
223-00	1/8	3.2
224-00	5/32	4.0
225-00	3/16	4.8

B. Alumina Nozzles

Part No.	Size	Diameter
130-00	#4	1/4
131-00	#5	5/16
132-00	#6	3/8
133-00	#7	7/16
134-00	#8	1/2
135-00	#9	9/16
136-00	#10	5/8

C. Long Alumina Nozzles*

Part No.	Size	Diameter
130-07	#4L	1/4
131-07	#5L	5/16
132-07	#6L	3/8
133-07	#7L	7/16

D. Quartz Nozzles (Glass -Vycor)*

Part No.	Size	Diameter
150-00	#4	1/4
151-00	#5	5/16
152-00	#6	3/8
153-00	#7	7/16
154-00	#8	1/2
155-00	#9	9/16
156-00	#10	5/8
157-00	#11	11/16

* Requires 200-NGR Gasket

A. Chucks

Part No.	Diameter	mm
223-07	1/8	3.2
224-07	5/32	4.0
225-07	3/16	4.8
226-07	1/4	6.4
227-07	5/16	8.0

B. Alumina Nozzles

Part No.	Size	Diameter
141-00	#5	5/16
142-00	#6	3/8
143-00	#7	7/16
144-00	#8	1/2
145-00	#10	5/8

Model 428: 350 Amp Torch

- Tapered design
- Color-coded, sheath protected hoses connects and disconnects without tools
- "Lectro-Lock" instant backcap lock for releasing of electrodes
- Silicone rubber insulation
- Accommodates 3" to 7" electrode length
- 100% continuous duty cycle, DC straight polarity
- Uses Alumina ceramic
- Electrode size: .020" - 5/32"
- Has replaceable teflon nozzle gasket

Part No. 428-12 12' Torch Assembly
Part No. 428-25 25' Torch Assembly

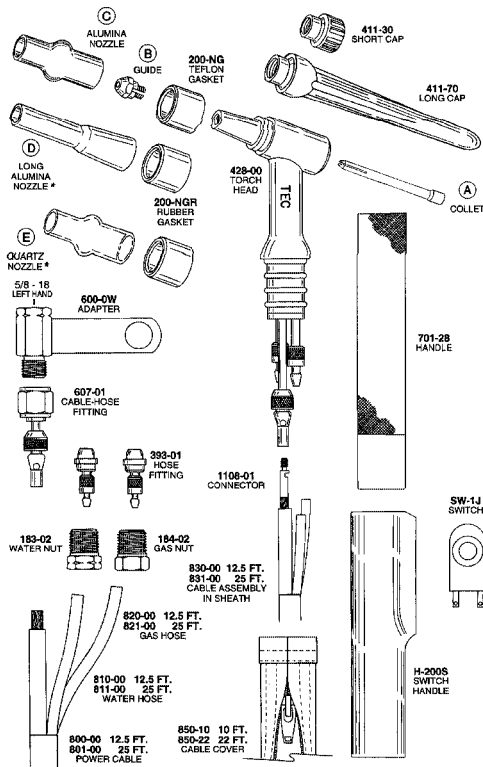

A. Collets

Part No.	Diameter	mm
962-01	.020	0.5
964-01	.040	1.0
965-01	1/16	1.6
966-01	3/32	2.4
967-01	1/8	3.2
968-01	5/32	4.0

B. Guides

Part No.	Diameter	mm
961-21	.020	0.5
961-41	.040	1.0
961-51	1/16	1.6
961-61	3/32	2.4
961-71	1/8	3.2
961-81	5/32	4.0

D. Long Alumina Nozzles*

Part No.	Size	Diameter
130-07	#4L	1/4
131-07	#5L	5/16
132-07	#6L	3/8
133-07	#7L	7/16

C. Alumina Nozzles

Part No.	Size	Diameter
130-00	#4	1/4
131-00	#5	5/16
132-00	#6	3/8
133-00	#7	7/16
134-00	#8	1/2
135-00	#9	9/16
136-00	#10	5/8

E. Quartz Nozzles (Glass -Vycor)*

Part No.	Size	Diameter
150-00	#4	1/4
151-00	#5	5/16
152-00	#6	3/8
153-00	#7	7/16
154-00	#8	1/2
155-00	#9	9/16
156-00	#10	5/8
157-00	#11	11/16

* Requires 200-NGR Gasket

Model 429: 300 Amp Torch

- Silicone rubber insulation
- Rainbow, color-coded, sheath protected hoses, connect and disconnect without tools
- Tapered design—no gaskets, insulators or seals
- AC rated for amperage performance
- 100% continuous duty cycle, DC straight polarity
- Lectro-lock instant backcap for releasing of electrodes
- Accommodates 3" - 7" electrode length
- Uses alumina ceramic
- Electrode size: .020" - 1/8"

Part No. 429-12 12' Torch Assembly
Part No. 429-25 25' Torch Assembly

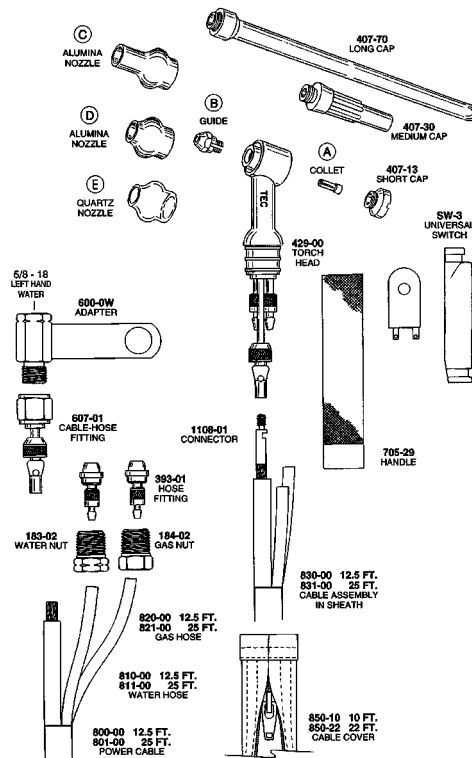

A. Collets

Part No.	Diameter	mm
104-421	.020	0.5
104-441	.040	1.0
104-451	1/16	1.6
104-461	3/32	2.4
104-471	1/8	3.2

B. Guides

Part No.	Diameter	mm
961-21	.020	0.5
961-41	.040	1.0
961-51	1/16	1.6
961-61	3/32	2.4
961-71	1/8	3.2

C. Alumina Nozzles

Part No.	Size	Diameter
130-11	#4	1/4
131-11	#5	5/16
132-11	#6	3/8
133-11	#7	7/16

D. Alumina Nozzles-Short

Part No.	Size	Diameter
130-01	#4	1/4
131-01	#5	5/16
132-01	#6	3/8
133-01	#7	7/16

E. Quartz Nozzles-Short (Glass -Vycor)

Part No.	Size	Diameter
150-01	#4	1/4
151-01	#5	5/16
152-01	#6	3/8
153-01	#7	7/16

TIG Spot Guns

Model 5000: 430 Amp Water Cooled Tig Spot Gun

- Production spot gun
- Operates up to 430 Amps on DC straight polarity
- Will spot weld such materials as mild steel, stainless steel, monel and inconel in the thickness of 1/8" or less
- Constructed of durable, long lasting materials
- Locators or tips are available for tacking inside or outside corners, flanges, butt, lap, "T" joints
- Accommodates .020" - 5/32" electrodes
- Electrode lengths 3" and 6"

Part No. 5000 25' Torch Assembly

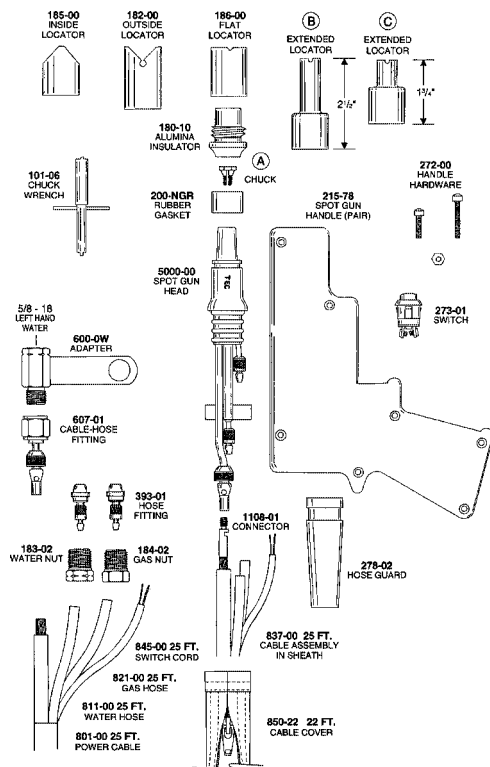

A. Chucks

Part No.	Diameter	mm
220-05	.020	0.5
220-00	.040	1.0
221-00	1/16	1.6
222-00	3/32	2.4
223-00	1/8	3.2
224-00	5/32	4.0

B. Extended Locator-Long

Part No.	Size	Diameter
188-437L	#5L	5/16
188-562L	#7L	7/16
188-687L	#9L	9/16

C. Extended Locator

Part No.	Size	Diameter
188-437	#5	5/16
188-562	#7	7/16
188-687	#9	9/16

Model 5505: 200 Amp Air Cooled Tig Spot Gun

- Light duty spot gun
- Operates up to 200 Amps on DC straight polarity
- Will spot weld such materials as mild steel, stainless steel, monel and inconel in the thickness of 1/8" or less
- Constructed of durable, long lasting materials
- Locators or tips are available for tacking inside or outside corners, flanges, butt, lap "T" joints
- Accommodates .020" - 5/32" electrodes
- Electrode lengths 3" and 6"

Part No. 5505 25' Torch Assembly

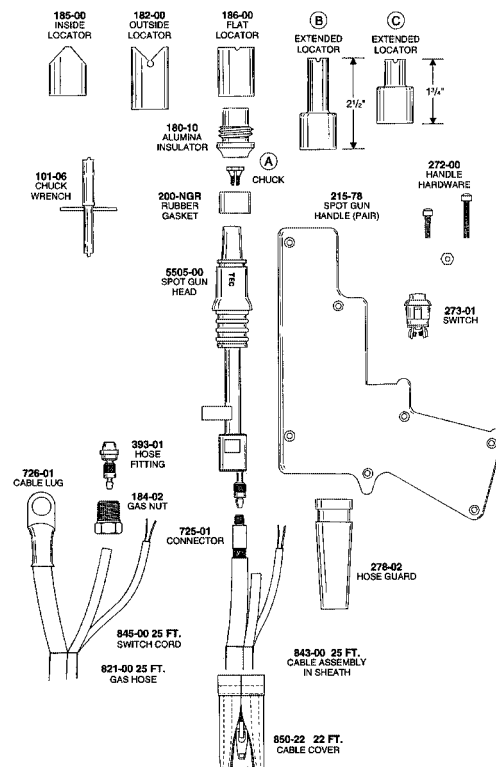

A. Chucks

Part No.	Diameter	mm
220-05	.020	0.5
220-00	.040	1.0
221-00	1/16	1.6
222-00	3/32	2.4
223-00	1/8	3.2
224-00	5/32	4.0

B. Extended Locator-Long

Part No.	Size	Diameter
188-437L	#5L	5/16
188-562L	#7L	7/16
188-687L	#9L	9/16

C. Extended Locator

Part No.	Size	Diameter
188-437	#5	5/16
188-562	#7	7/16
188-687	#9	9/16